

PRP26A MANUAL POP RIVET TOOL

- A reliable tool, ideal for sheet metal and similar applications where power is not available.
- Sets rivets from 3/32" through 5/32" diameters.
- Furnished with standard nosepiece to set 1/8" and 5/32" rivets.

LUBRICATION GUIDE

Grease Guide Slots
Oil Sides of Jaw
Oil Pins and Pin Holes

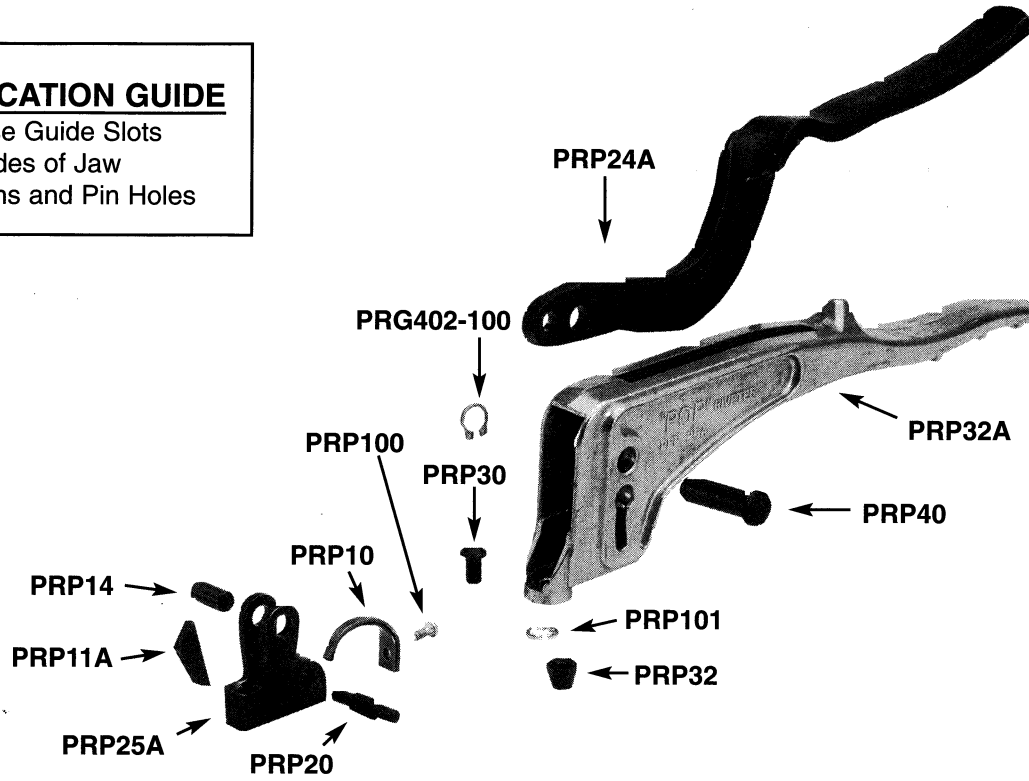

PARTS LIST FOR PLIERS PRP26A

PARTS NO.	DESCRIPTION	QUANTITY
PRG402-100	Fulcrum Pin Retainer	1
PRP10	Collet Spring	1
‡PRP11A	Jaw (Type "C" for 1/8" Dia. Open End "Pop" Rivets)	1
*PRP12A	Jaw (Type "D" for 5/32" Dia. Open End "Pop" Rivets)	1
PRP14	Link Pin (For Securing 25A to 24A)	1
PRP20	Guide Pin	1
PRP23A	Support	1
PRP24A	Lever	1
PRP25A	Collet Case	1
*PRP27	Jaw (Type "B" for 1/8" Dia. Closed End "Pop" Rivets and 3/32" Dia. Open End "Pop" Rivets)	1
PRP30	Jaw Pusher	1
*PRP31	Nosepiece Nut (For 3/32" Dia. Open End "Pop" Rivets)	1
‡PRP32	Nosepiece Nut (For 1/8" Dia. Open End "Pop" Rivets)	1
‡*PRP33A	Nosepiece Nut (For 5/32" Dia. Open End "Pop" Rivets)	1
*PRP39	Nosepiece Nut (For 1/8" Dia. Closed End "Pop" Rivets)	1
PRP40	Fulcrum Pin	1
PRP100	Collet Spring Screw (Rd. Hd. Mach. No. 4-40NC x 1/4")	1
PRP101	Jaw Pusher Washer	1

*Not Regular Equipment. Must be ordered separately.

‡Also used with Closed End Aluminum Rivets with Aluminum Mandrels only.

See Chart on Front Page