

DYN-O-LOC®

Conduit can be used to support duct sizes over 48" or smaller duct in high pressure applications. Dyn-O-Locs insert into the hollow ends of conduit to provide a means of attaching the conduit to the duct.

Available for use with
1/2" or 3/4" Conduit

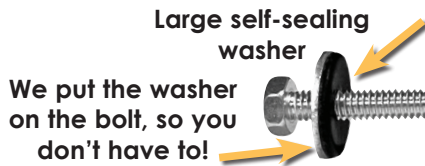

We put the washer
on the bolt, so you
don't have to!

Long bolt for
easier installation



Installed lock is pull
tested to withstand
over 1900 lbs.

Locks conveniently
packed in separate
poly bag.



Bolts (with washer
attached) packed
underneath locks.

Item #	Code	Description	Quantity
21097	DOMRL12	1/2" Dyn-O-Loc*	250/Box
21098	DOMRL34	3/4" Dyn-O-Loc*	250/Box
21208	DOMRL12-100	1/2" Dyn-O-Loc	100/Box
21209	DOMRL34-100	3/4" Dyn-O-Loc	100/Box
*Dyn-O-Locs included with Rod Loc Insertion Machine.			
ALSO AVAILABLE SEPARATELY:			
21008	SN12-250	1/2in Dyn-O-Loc Spring Nut Only	250/Box
21009	SN34-250	3/4in Dyn-O-Loc Spring Nut Only	250/Box
21286	SWW1420-250	1/4-20 Dyn-O-Loc Bolt with Washer	250/Box

D-STUD™

The D-Stud is a Dyn-O-Loc with the threaded stud pre-attached.

- Properly installed D-Studs are pull tested to over 1300 lbs.
- Anchors conduit in place during installation.
- Works with both insulated and non-insulated duct work.
- Allows for the installer to easily locate the pre-drilled hole.

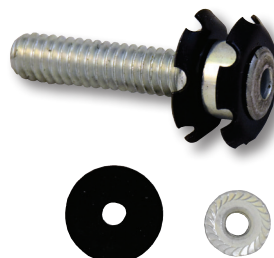

Item #	Code	Description	Quantity
13021	DS12K-250	1/2" Dyn-O-Loc D-Stud™ Kit	250/Box
13023	DS34K-250	3/4" Dyn-O-Loc D-Stud™ Kit	250/Box
13025	DS12-250	1/2" Dyn-O-Loc D-Stud™ Only	250/Box
13027	DS34-250	3/4" Dyn-O-Loc D-Stud™ Only	250/Box
13029	DSGW-250	Dyn-O-Loc D-Stud™ Gasket Washer	250/Box
13031	DSFN-250	Dyn-O-Loc D-Stud™ Flange Nut	250/Box



See reverse side for associated products!

ROD LOC INSERTION MACHINE

The Rod-Loc Insertion Machine offers contractors a fast and convenient way to set up rod locks and conduit. It runs off of a standard 110 volt outlet and a 70 PSI minimum air supply. Simply place either 3/4" or 1/2" conduit in the cradle and a rod loc on each side, and by the flip of a switch the air cylinder inserts a rod lock on both ends simultaneously of hollow conduit at the perfect inset spacing, eliminating the old timely hammer in method!

Item #	Code	Description
43009	WVDL1234	Rod-Loc Insertion Machine

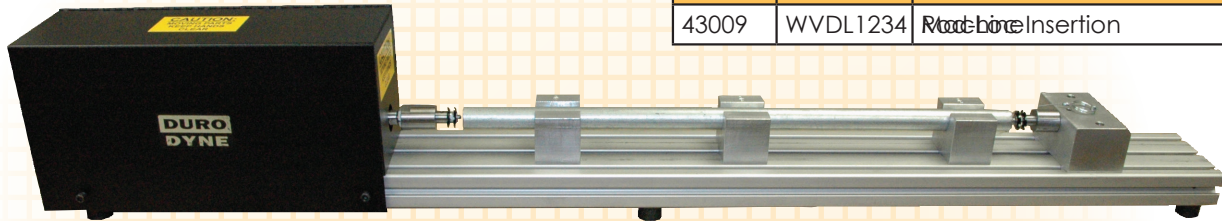

Each machine is packed with a bag of both 1/2" and 3/4" Dyn-O-Locs to get you started!

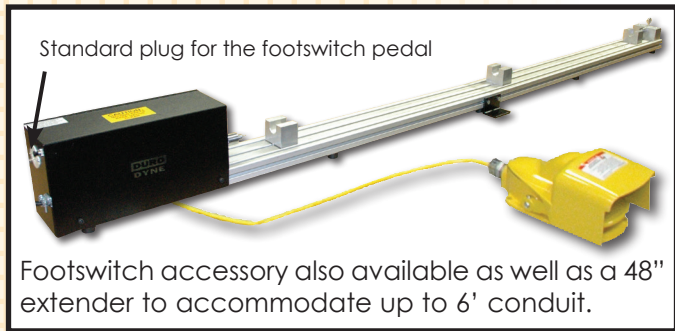
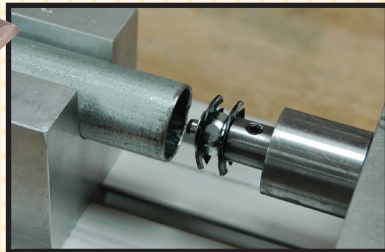

Footswitch accessory also available as well as a 48" extender to accommodate up to 6' conduit.

For more details, please see our Rod Loc Insertion Machine Literature Sheet.

DUAL DYN-O-CLAW™

The Dyn-O-Claw is designed to join conduits for more stability and to eliminate their vibration in the duct



Works for 1/2" & 3/4" conduit

Easier and faster than other alternatives such as ties or welding



The Dual Dyn-O-Claw is designed to join conduits and eliminate their vibration in the duct. Dual Dyn-O-Claws are easier and faster than other alternatives such as ties or welding, and work on both 1/2" and 3/4" conduit.

Item #	Code	Description	Pkg.	Weight (lbs.)
21298	DOMDOC1234	Dual Dyn-O-Claw 1/2" & 3/4"	250/Box	40

Also available:
Air Tools featuring Dyn-O-Loc Insertion Tool and D-Stud Insertion Tool



Dyn-O-Loc Manual Insertion tool assures accurate spacing

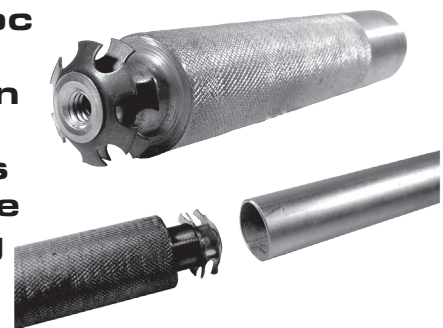

Duro Dyne Corporate Headquarters, Bay Shore, NY
631-249-9000 • Fax: 631-249-8346
Duro Dyne Midwest • Duro Dyne West • Duro Dyne Canada
www.durodyne.com • E-mail: durodyne@durodyne.com

DURO DYNE®
© Duro Dyne Corp.
Printed in USA 6/20/18
BF013414