

AHU Viewport Panel



**Effective for viewing
working Ultra Violet lights**

Installed in air handling units with wall/panel thickness up to 3"

- 4" x 2 $\frac{5}{8}$ " viewport
- 2 layers of safety glass
- Tested to 10" w.g. positive/negative



DUCTMATE[®]
Industries, Inc.

AHU Viewport Panel

Effective for viewing working UV lights

DESCRIPTION

The AHU Viewport Panel provides a safe, effective means to view working UVC Emitters inside an air handling unit (AHU) with an insulated wall thickness of up to 3". The AHU Viewport Panel includes 2 layers of laminated safety glass with a 4" x 2 5/8" clear window.

BASIC USE

It provides the ability to view the interior of the air handling unit through clear safety glass, eliminating the need to open the panel, disconnect circuits, or risk exposure to ultra violet light.

SPECIAL CHARACTERISTICS

- 4" x 2 5/8" viewport
- 2 layers of safety glass
- Tested to 10" w.g. positive/negative

TECHNICAL INFORMATION

- PANELS**
The AHU Viewport Panel consists of two layers of precision stamped hot-dipped galvanized steel.
- GASKET**
Closed cell neoprene gasket is UL94HF1 listed with a service temperature range of (ASTM D746) -20°F to 200°F. The gasket is permanently bonded to the inside of both panels to eliminate leakage.
- WING NUTS**
Zinc plated steel wing nuts are easily turned by hand.
- BOLTS**
4" zinc plated steel carriage bolts are secured to the inner panel.
- GLASS**
2 layers of 1/4" safety glass permanently sealed with silicone
- CLIPS**
Hot-dipped galvanized steel clips mechanically fastens the safety glass in place.
- TEMPLATE**
Self adhesive template is provided for the exact size of duct opening required.

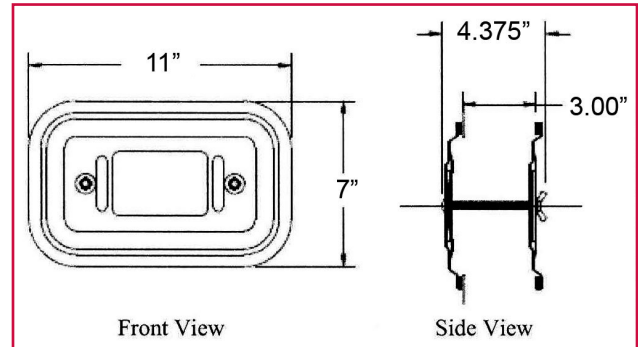

PACKAGING INFORMATION

Size	Part No.	Gage
10" x 6"	DO106GA4*	22

* Also available for 4" wall thickness use DO106GA6

INSTALLATION INSTRUCTIONS

1. Peel backing off template and apply to duct.
2. Cut opening in duct as shown by template.
3. Loosen wing nuts, but do not remove.
4. Insert panel into opening at an angle and center in opening with wing nuts **on inside of panel**.
5. Finger-tighten wing nuts to secure panel in place.

LIMITED PRODUCT WARRANTY

Ductmate warrants that the AHU Viewport Panel when properly installed and maintained, will be free from defects in material and workmanship, and will comply with all written specifications made by Ductmate at the time of sale. Ductmate's warranty shall run for a period of one year from the date of manufacture.

Warranty Limitation:

The warranty stated above is in lieu of all other warranties, express or implied, including but not limited to the implied warranties of MERCHANTABILITY AND FITNESS FOR A PARTICULAR PURPOSE. Although Ductmate may have suggested the product, or provided written or oral advice to the Purchaser, it is the Purchaser's responsibility to test and determine the suitability of the AHU Viewport Panel, for the intended use and purpose, and Purchaser and/or its customer assumes all risk and liability whatsoever regarding such suitability.

Limitation of Liability:

In the event of a breach of the above warranty, Ductmate's sole obligation, and Purchaser's sole and exclusive remedy, shall be, at Ductmate's option, repair or replacement of any defective products, or refund of an applicable portion of the purchase price. Ductmate shall have no liability for costs of removal or reinstallation of the product. The Purchaser agrees that no other remedy, including but not limited to loss of profits, loss sales, injury to person or property, or any other special, incidental or consequential damages, shall be available to the Purchaser for any claim arising out of this Agreement, regardless of whether such claim is made in contract or in tort, including strict liability in tort. In no event will Ductmate be obligated to pay damages to the Purchaser in any amount exceeding the purchase price that the Purchaser paid to Ductmate for the allegedly defective product.



Charleroi, PA
210 Fifth Street
Charleroi, PA 15022
724-258-0500

Lodi, CA
810 S. Cluff Avenue
Lodi, CA 95240-9141
209-333-4680

*Additional Manufacturing and Warehousing in
Monongahela, PA and Wagoner, OK*

1-800-245-3188 • www.ductmate.com

© Copyright Ductmate Industries, Inc. All rights reserved.



Ductmate Is A Proud Member Of The Following Organizations:



Distributed By: